

Halton General Hospital

Warrington and Halton Hospitals

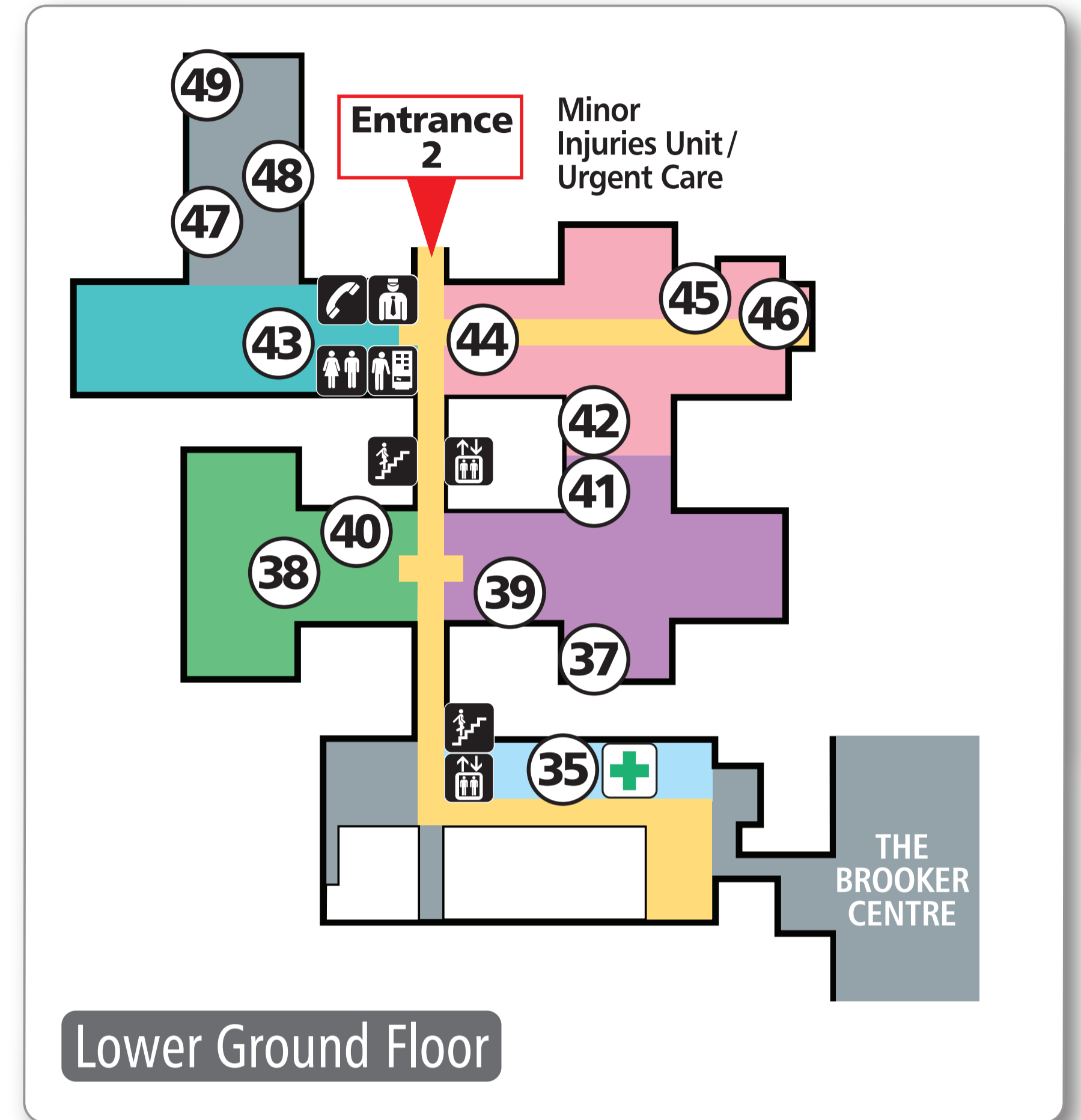

NHS Foundation Trust

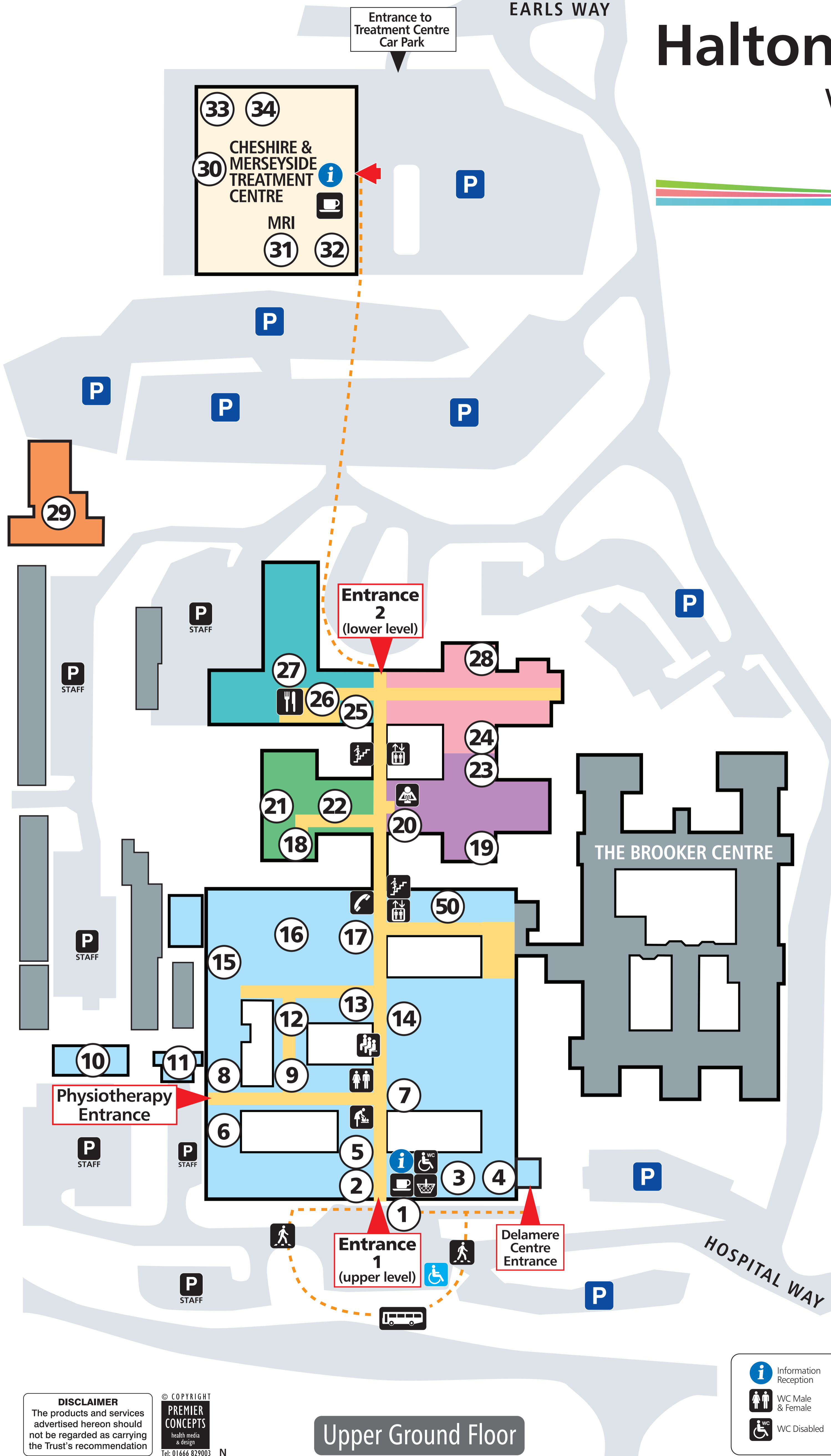

Department	Floor	Ref	Department	Floor	Ref
Appliance Office	upper	9	Operating Theatres	upper	22
Audiology	upper	7	Oral & Maxillo Facial	upper	13
Blood Tests	upper	9	Orthodontics	upper	13
CANtreat Chemotherapy Centre	upper	50	Orthoptist	upper	12
Cardiac Rehab	lower	43	Outpatient Clinic A	upper	9
Catering Dept	upper	27	Outpatient Clinic B	upper	12
Chapel	upper	20	Outpatient Clinic C	upper	7
Chronic Pain Team	lower	42	PALS Officer	lower	42
Colposcopy	upper	12	Pathology	lower	40
Community Day Unit	lower	46	Pharmacy	lower	35
Community Therapy Team	upper	3	Physiotherapy	upper	6
Day Case Surgery	upper	17	Pre-Operations Suite	upper	18
Delamere Centre & Breast Screening	upper	4	Programmed Investigations Unit	upper	24
Diabetes Sister	upper	12	Rehabilitation Gym	lower	39
Dietetics	upper	8	Restaurant	upper	26
ECG Dept	upper	15	Rheumatology	upper	12
Education Centre	external	29	Runcorn Emergency Doctor	lower	45
Endoscopy Unit	upper	16	Shops, Tea Bar & Info Desk	upper	1
Estates Workshop	lower	49	Speech & Language Therapy	upper	6
General Office	upper	2	TSSU	upper	21
GUM Services	external	10	Union Office	upper	11
Halton Dialysis Centre	lower	38	Ward B2	lower	41
Health Advisor	upper	12	Ward B3	upper	19
Holistic Therapies	upper	25	Ward B4	upper	23
Hospital Mortuary	lower	47	X-Ray & Ultrasound	upper	14
Hospital Radio	lower	48			
Intermediate Care Ward	lower	37	Cheshire & Merseyside Treatment Centre	G	30
League of Friends	upper	11	Café (Treatment Centre)	G	32
Medical Engineering & Supplies	lower	47	Imaging (X-Ray, MRI, CT, Ultrasound)	G	31
Medical Records	upper	3	Physiotherapy	G	34
Minor Injuries Unit	lower	44	Ward (Treatment Centre)	1	33
Occupational Therapy	upper	5			

Information Reception	Link Corridors	Baby Changing	Stairs	Shop	Pharmacy	Disabled Car Parking
WC Male & Female	Entrances	Café Teabar	Public Telephone	Vending Machine	Porter	Patient & Visitor Car Parking
WC Disabled	Lift	Restaurant	Chapel	Waiting Area	Footpath	Hospital Shuttle Bus Stop

DISCLAIMER
The products and services advertised hereon should not be regarded as carrying the Trust's recommendation

© COPYRIGHT
PREMIER CONCEPTS
health media & design
Tel: 01666 829003 N

Upper Ground Floor